

Innospann Steel-Plate ISST

Hole grid measure 75 mm and 150 mm

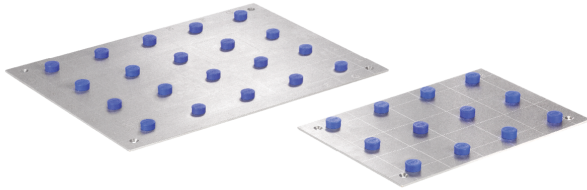

Innospann Steel-Plate ISST

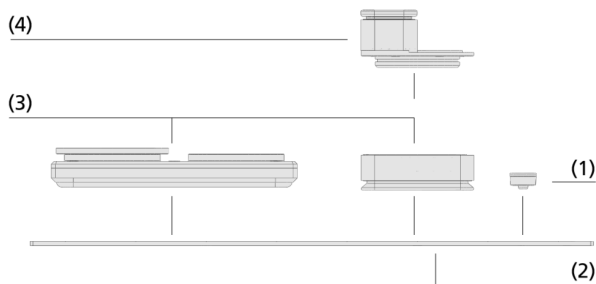

System design Innospann Steel-Plate ISST



Innospann Steel-Plate with Mono-Bases and suction cups

Suitability for industry specific applications

Application

- Vacuum clamping system for retrofitting CNC machining centers with flat, grid or console tables
- Facilitates efficient and flexible single piece and small series production especially for the manufacture of furniture
- The suction cup mountings Mono-Base and Quad-Base are fitted with suction cups and can be positioned freely on the Steel-Plate
- A laser grid provides orientation assistance
- Unused vacuum openings can be closed manually using sealing magnets
- Variable total height through various suction cup heights and optional spacer rings

Design

- Unused vacuum openings can be closed with sealing magnets (1)
- Innospann Steel-Plate (2) made from high-quality stainless or galvanized steel with integrated vacuum openings
- Suction cup mountings (3): Mono-Base or Quad-Base
- Suction cups (4) in various shapes

Product highlights

- Can be retrofitted on all common machine types (flat, grid and console tables)
- Two different valve distances allow free positioning of Mono-Bases and Quad-Bases
- Lasered grid as orientation aid for positioning the suction cup
- Flexible use and short set-up times thanks to sealing magnets for uncovered vacuum openings

Innospann Steel-Plate ISST

Hole grid measure 75 mm and 150 mm

Designation code Innospann Steel-Plate ISST

| | | | | | | |
|-------------|---|-----------|---|-----------------|---|-----------|
| ISST | – | MS | – | variabel | – | 75 |
| 1 | | 2 | | 3 | | 4 |

1 – Abbreviated designation

| Code | Type |
|------|-----------------------|
| ISST | Innospann Steel-Plate |

2 – Version

| Code | Type |
|------|------------------|
| MS | Sealing magnet |
| TVR | Touch ball valve |

3 – Dimensions

| Code | LxWxH in mm |
|----------|-------------|
| variabel | Variable |

4 – Valve spacing

| Code | Valve spacing in mm |
|----------|---------------------|
| 75...150 | 75 and 150 |

The Steel-Plate ISST is delivered assembled. The product consists of:

- Stainless steel plate or galvanized steel made to measure with hole pattern and laser grid

Available accessories: sealing magnets